

P10768V150I_T01

15.0 Inches, 1024xRGBx768, 65K Colors, UNICView LCM

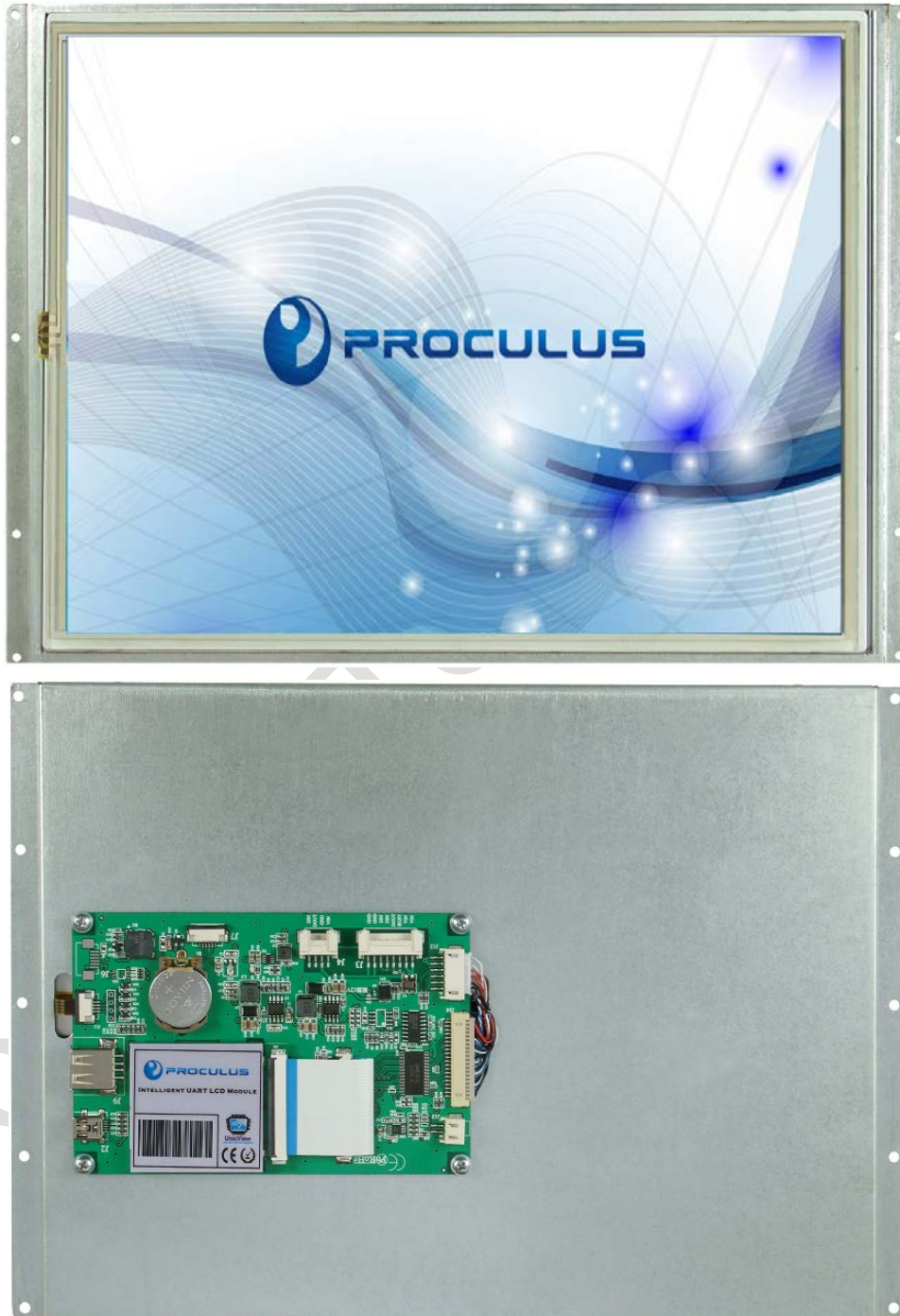

● Display

Item	Parameter	Description
Color	65K (65536) colors	16 bit color 5R6G5B
Visual Angle L/R/U/D	80° /80° /65° /80°	
Resolution	1024*768	90° rotated display (768*1024)
Backlight /Lifecycle/Brightness	LED/50,000 HOURS/ 400 cd/m ²	
Working Temperature/ Storage Temperature	-20~+70°C/-30~+80°C	

● Voltage & Current

Item	Conditions	Min	Typ	Max	Unit
Power Voltage	Short-circuit J14-	10.2	12	13.8	V
	Break J14 (Default)	13	24	42	V
Operation Current	VIN = 12V, Backlight on	-	640	-	mA
	VIN = 24V, Backlight on	-	325	-	mA
	VIN = 12V, Backlight off	-	90	-	mA

● Interface

Item	Conditions	Min	Typ	Max	Unit
Baudrate	Standard	1200	115200	892900	bps
Interface	RS-232C				
Data Format	1 byte for initial, 8 bytes for data, invalid bytes for checksum, 1 byte for end				
Socket	SMD2.0-8P with lock catch				

● Peripherals

No.	Parameter	Description
1	Touch Screen	4-wire resistance touch screen: P10768V150I_T01 No touch screen: P10768V150I_N01
2	Buzzer	YES
3	RTC	YES
4	USB	YES. For downloading offline or user data copy.
5	USB Mini	YES. For online debugging.
6	Audio	Support *.MP3 files. Theoretically 4096 file at maximum. Speaker power: 4 Ω 2W or 8 Ω 2W.
7	Keyboard	Support external row keyboard (8*8 maximum).
8	Memory	128M(support *.jpg files, maximum 65536 files theoretically), extended to 1G at maximum.



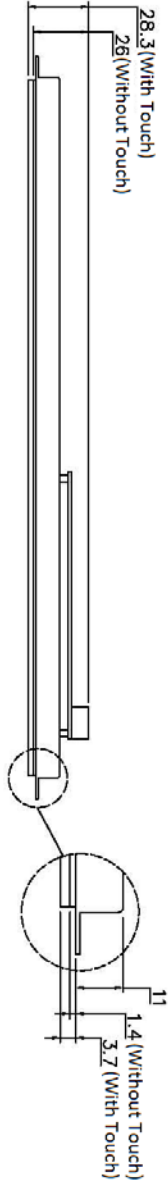
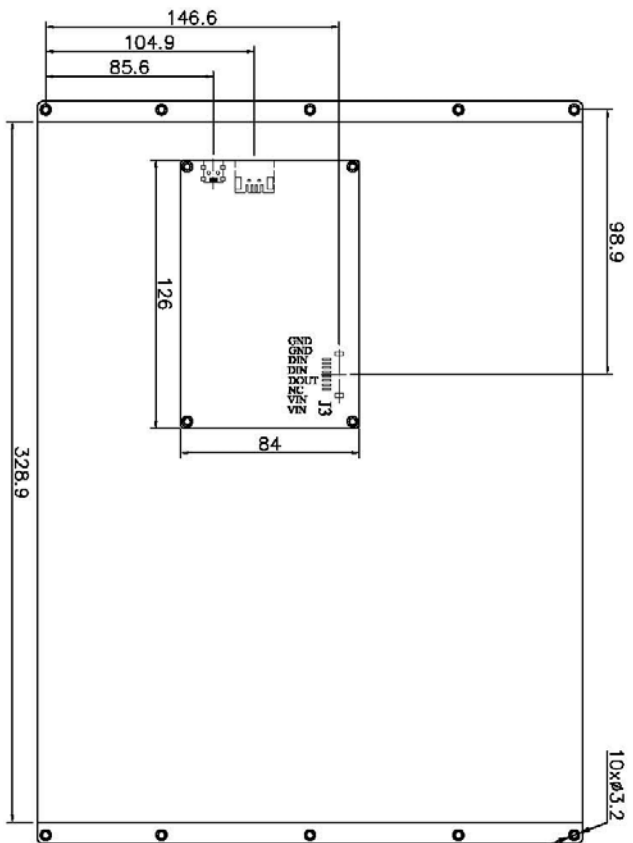
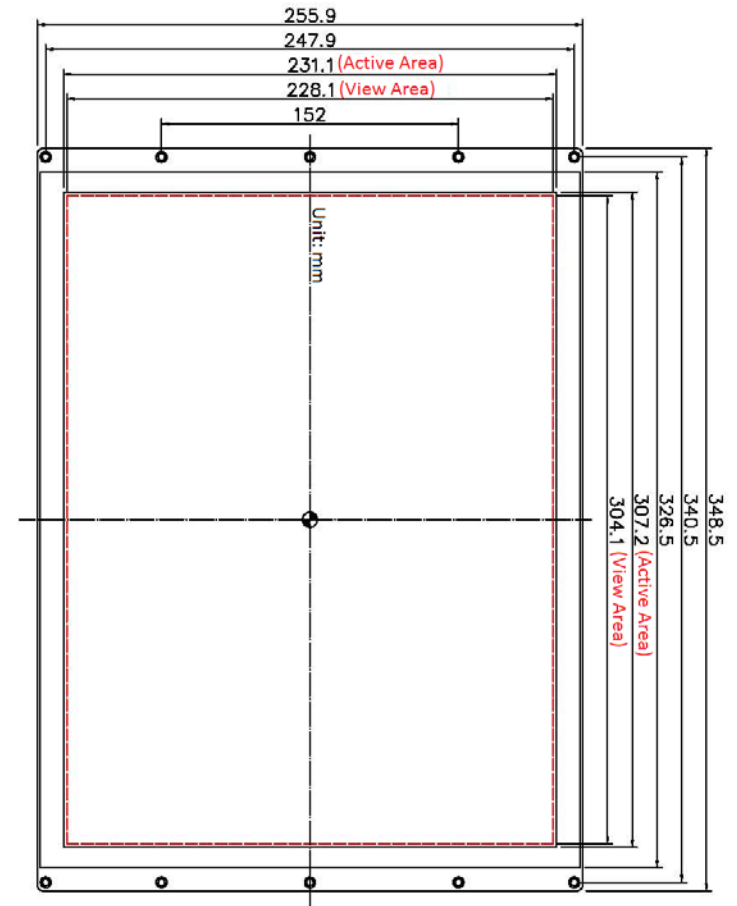

Technical Requirement:
1. Material of shell: 1mm thick galvanized sheet.

Pin Name	J3 Pin Num.	Remarks
VIN	7,8	POWER INPUT
GND	1,2	GND
DIN	3,4	DIN
DOUT	5	DOUT
NC	6	Not defined

Part No.	P10768V150I_T01			 PROCLUS TECHNOLOGIES INC.
Datasheet	Drawn by	Proclus	Date	
Proportion	1:1	Verified by	Date	
Unit	mm	Confirmed by	Date	